

GalvinAssist WF Clean Flush Toilet Pan + Seat

PRODUCT CODE

- 105.11.20.00



SPECIFICATIONS

Pan – details:

- Stylish minimalist design that sits flat against the wall
- Clean Flush rimless pan
- Easy Care Height pan
- Compliant with AS1428.1 Ambulant guidelines
- White vitreous china with nanoglaze surface, easy to clean
- Soft-closing, easy-clean quick release seat with stainless steel pins
- Compatible with in-wall cistern pneumatic actuation, Galvin item number 105.94.00.00 (not supplied)

IMPORTANT:

- Installation shall be in accordance with AS/NZS3500.
- All measurements are in millimeters. Height dimensions are to base of pan. Make allowance for bedding.
- Dimensions are nominal and subject to normal ceramic manufacturing variations.
- If bedding: Pan may be bedded with cement base or using silicone sealant. Fix pan to floor using a sand cement mixture of 3:1 to a depth of 60mm. Do not use lime or fast-drying cement.
- If using bracket fixing: The pan should be bedded with silicone sealant and fixed with the brackets supplied.
- Do NOT use epoxy type adhesives.
- Clean with a damp cloth. Do not use abrasive cleaners, liquids, or pastes.
- Specifications may vary without notice as part of our continuous improvement practices.

WARNINGS: Special attentions to be paid on notes, photos, images, or drawings of assembly steps marked with the warning symbol.



TECHNICAL DATA

Pan	Wall faced with rimless Clean Flush pan design.
Material	White vitreous china
Traps	Universal trap, suitable for S or P trap installations (P-trap connector not supplied.)
Seat	Quick release seat with stainless steel hinges, soft closing.
Setout	Variable 90-120 mm using supplied connector.
Fixing	Pan may be bedded with cement base or using silicone sealant.
WELS	4 star rating 4.5/3 Liter water saving flush

NOTE: Galvin Engineering continually strive to improve their products. Specifications may change without notice.

PACKAGE CONTENTS

Pan Package Contents

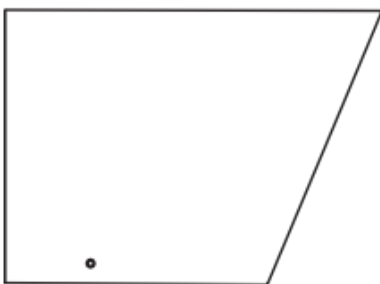

1 x ceramic pan

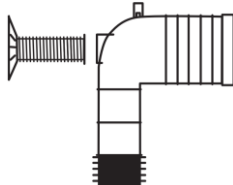

1 x pan connector
1 x threaded section (with flange plate)

For connecting pan to floor outlet pipe/S-trap.
Flange attaches to wall; threaded section links to pan connector.

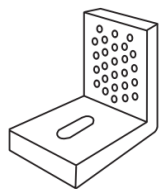

2 x concealed fixing brackets

Optional fixing #2 — can be used to connect pan to floor.



2 x floor bolts (and white plugs), 2 x washers

Optional fixing #2 — used with fixing brackets to secure pan to floor.



2 x caps, 2 x screws and 2 x pan plugs

Optional fixing #2 — used to secure pan to concealed fixing bracket.

Toilet Seat Package Contents

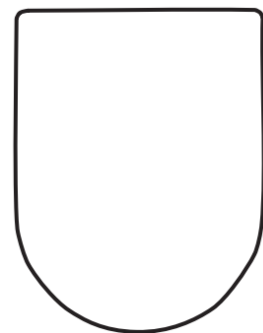

1 x seat and lid

With receptor holes that slide onto stainless steel pins.



Seat Fittings:

2 x stainless steel caps (used to cover stainless steel plate with pin),
2 x stainless steel plates with pin (seat locates onto stainless steel pins)
2 x metal bolts (used for securing stainless steel plate and pin to pan).

PRE-INSTALLATION



Notes:

- Inspect the components before installation to ensure there are no visible defects. If a defect is found, do not install the toilet suite and contact the supplier immediately. Claims for defects will not be accepted after the product has been installed.
- Product must be installed by a licensed plumber. Failure to do so may void the warranty.
- Refer to pan specifications for dimensions from finished floor level (FFL) to pan inlet and outlet.
- These instructions show toilet pan installation. To install cistern, refer to the in-wall toilet system instructions or contact Galvin Engineering.
- An in-wall cistern must be installed before fitting the toilet pan.

IN-WALL CISTERN REQUIREMENT

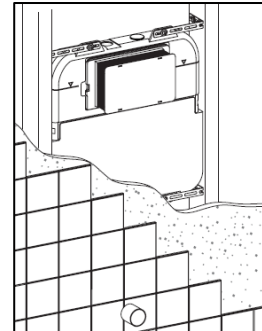

DIMENSIONS

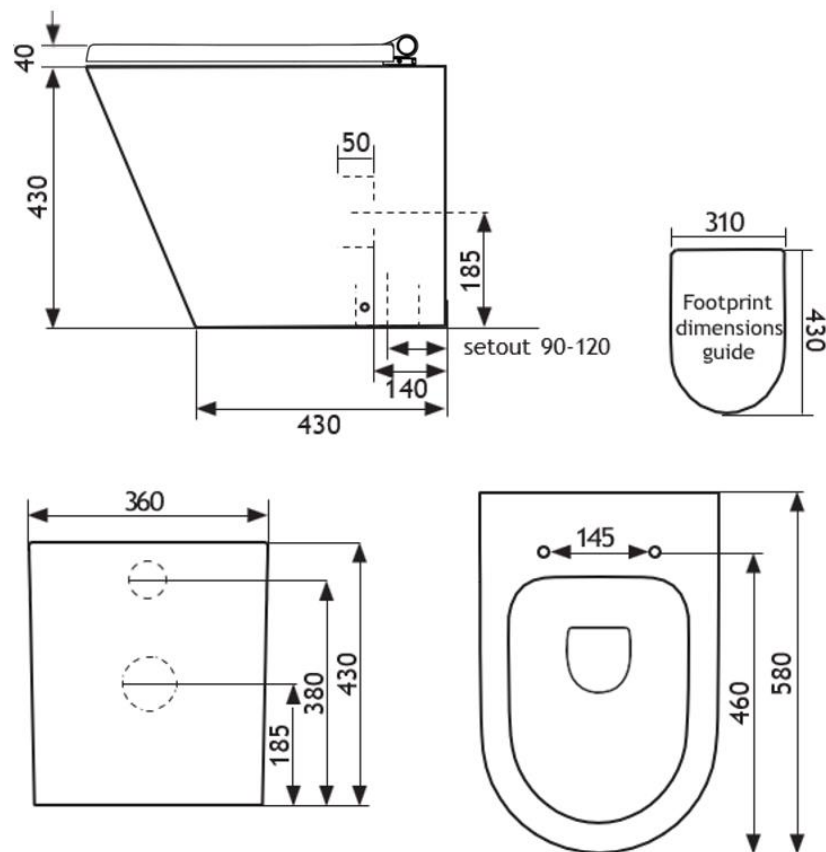

INSTALLATION

INSTALLATION COMPLIANCE: Galvin Engineering products must be installed in accordance with these installation instructions and in accordance with AS/NZS 3500, the PCA and your local regulatory requirements. Water and/or electrical supply conditions must also comply to the applicable national and/or state standards. Failing to comply with these provisions shall void the product warranty and may affect the performance of the product.

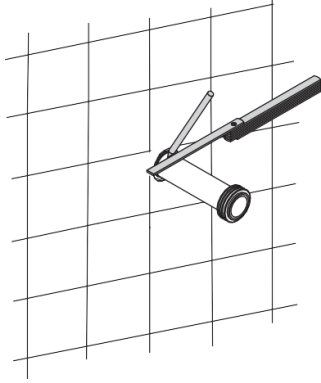

1. Measure the required length for the flush pipe (not supplied)

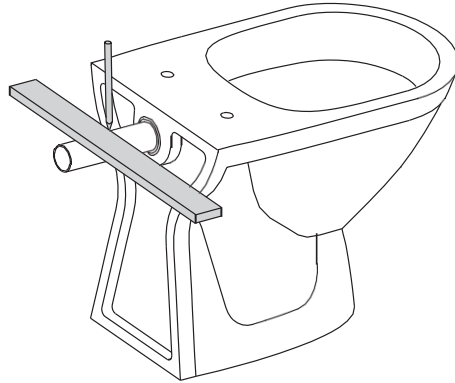

2. Mark flush pipe for cutting

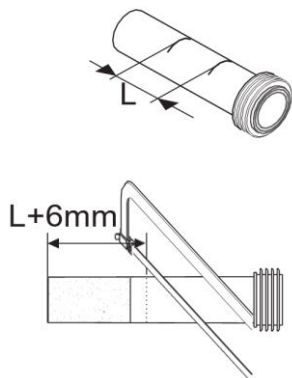

3. Add 6mm to the marked location and cut.

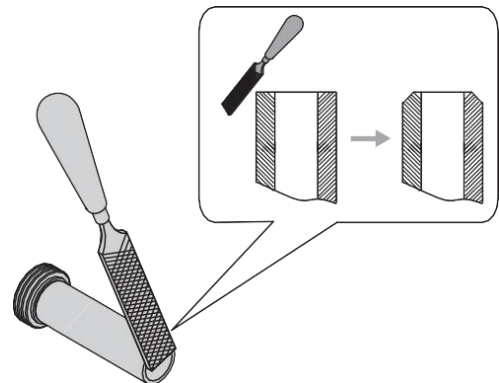

4. Remove any burrs and add chamfer to the end of the flush pipe.

5. Secure the pan connector in place (S-trap procedure).

- Determine the centre of the pan and mark the centre line on the floor and wall.
- Work out the setout required for your specific site installation.
Setout range: 90-120.
- You may need to trim the large end of the plastic pan connector to fit the required setout. To trim, first remove the plastic ring and rubber seal, then cut pipe to size. Refit rubber seal and plastic ring securely, ensuring a good fit.
- Position the pan connector into the floor outlet pipe (S-trap).
- Height measurement from the floor to the centre of the pan connector: **185mm**.
- Slot the threaded section (with flange plate) onto the pan connector, ensuring that the flange plate is touching the wall. You may need to trim the threaded section so that it fits properly.
- Mark and drill the flange plate holes and secure the plate to the wall with fixing screws. The pan connector is now installed.

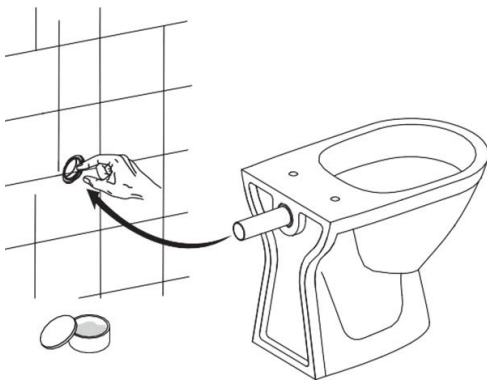
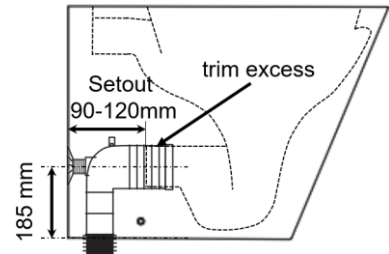

6. Remove dust cover and push the pan in place.

- Use the centre line marked on the wall and floor to position the pan in Step 5.
- Push the pan into the installed plastic pan connector. It is recommended that wedges are used to support the foot of the pan during positioning.



Note: if using floor brackets (Optional fixing #2), brackets will need to be installed before placing pan in final position.



7. Check level and secure pan in place using one of the below fixing methods:

Cement fixing (Optional fixing #1)

If using cement bedding, level the pan while the cement mixture is workable. Fix pan to floor using a sand cement mixture of 3:1 to a depth of 60mm. Do not use lime or fastdrying cement.



Important: Allow at least 24 hours for the cement mixture to set before using the toilet.

Bracket fixing (Optional fixing #2)

- Position the concealed fixing brackets in line with the bracket fixing holes.
- Screw the floor bolts in place through the base of the brackets.
- Bed the pan with acetic cured silicone sealant, ensuring that the pan is level.
- Secure the pan to the brackets using the plastic pan plugs and rebated screws.
- The caps can be used to cover the plugs on each side of the pan.

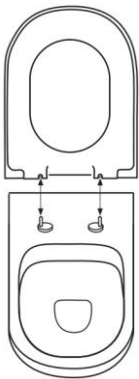

Important: Do not over-tighten the bolts or screws as this may cause the ceramic to crack and break.

**8. Install Seat**

- Secure the toggle bolts into the seat connection holes, ensuring that the stainless steel pins line up with the receptor holes in the seat. Once correctly placed, ensure that the bolts are properly tightened.
- Slide the stainless steel caps onto the plates with pins.
- To fit the seat, slide it onto the stainless steel pins. You may need to make adjustments to position the seat correctly.
- To release the seat, put the seat in an upright position, press the buttons on the seat and lift upwards.

TROUBLESHOOTING

PROBLEM	CAUSE	RECTIFICATION
Continuous water flow into the toilet bowl	In-wall cistern components are damaged	Check in-wall cistern components (valve assembly, seals, etc.). Replace if damaged.
Leakage between the cistern and the toilet pan	Flush pipe is detached or not fitted properly.	Ensure flush pipe is fitted correctly and rubber seals is intact. Replace seal if damaged.

WARRANTY

Galvin Engineering products are covered under our Manufacturer's Warranty. Galvin Engineering products must be installed in accordance with the installation instructions and in accordance with AS 3500 and NCC Volume Three, relevant Australian Standards and local authorities applicable to product being installed. Water and electrical supply conditions must also comply to the applicable national and/or state standards, failing to comply with these provisions may void the product warranty and affect performance of the product.

Please visit www.galvinengineering.com.au to view the full warranty, our Installation Compliance and Maintenance & Cleaning information as well as any other additional information.

Within Australia: 1300 514 074 Outside Australia: P: +61 (0)8 9338 2344

F: +61 (0)8 9338 2340

sales@galvinengineering.com.au

www.galvinengineering.com.au

ABN: 78 008 719 382

PERTH | SYDNEY | MELBOURNE | BRISBANE | ADELAIDE

